

journeys & places

Update on Town Centres
Regeneration & Economic Development
Scrutiny Panel

Oct'23



Action Plans

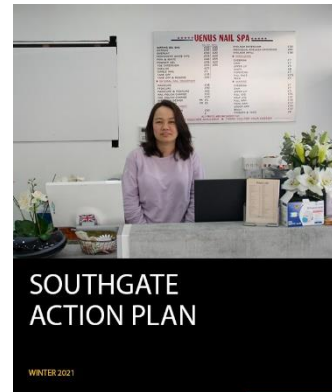

- Published in 2022
- Commissioning update of plans to be launched in new year 2024
 - Review work delivered to date
 - Engagement with key community stakeholders to review
 - Bring together Town Centre Development and Curate Enfield
 - Borough-wide **Place Shaping Action Plan**

Enfield Town



Palace Gardens

- Planning officers are considering proposals to Palace Gardens Square, which is located on the interior of the shopping centre site, between the rear of Pearsons and Marks & Spencer.
- Pearsons are proposing to infill their colonnade space - that faces the square - with expanded retail floorspace so the shop frontage can better engage with the open space.
- The Palace Gardens owner is proposing upgrades to resolve level changes and unify the landscape elements, with improved paving, planting, seating and lighting.
- Both applications have been subject to public consultation and decisions on the applications are anticipated in September/October.



Enfield Town Liveable Neighbourhood



- Concept designs have been completed with 4 stages of community engagement held
- Detail designs for Phase 1 works are progressing well. Statutory consultation are expected in February 2024, with phase 1 works expected to start in the second half of 2024.

Enfield Town Liveable Neighbourhood

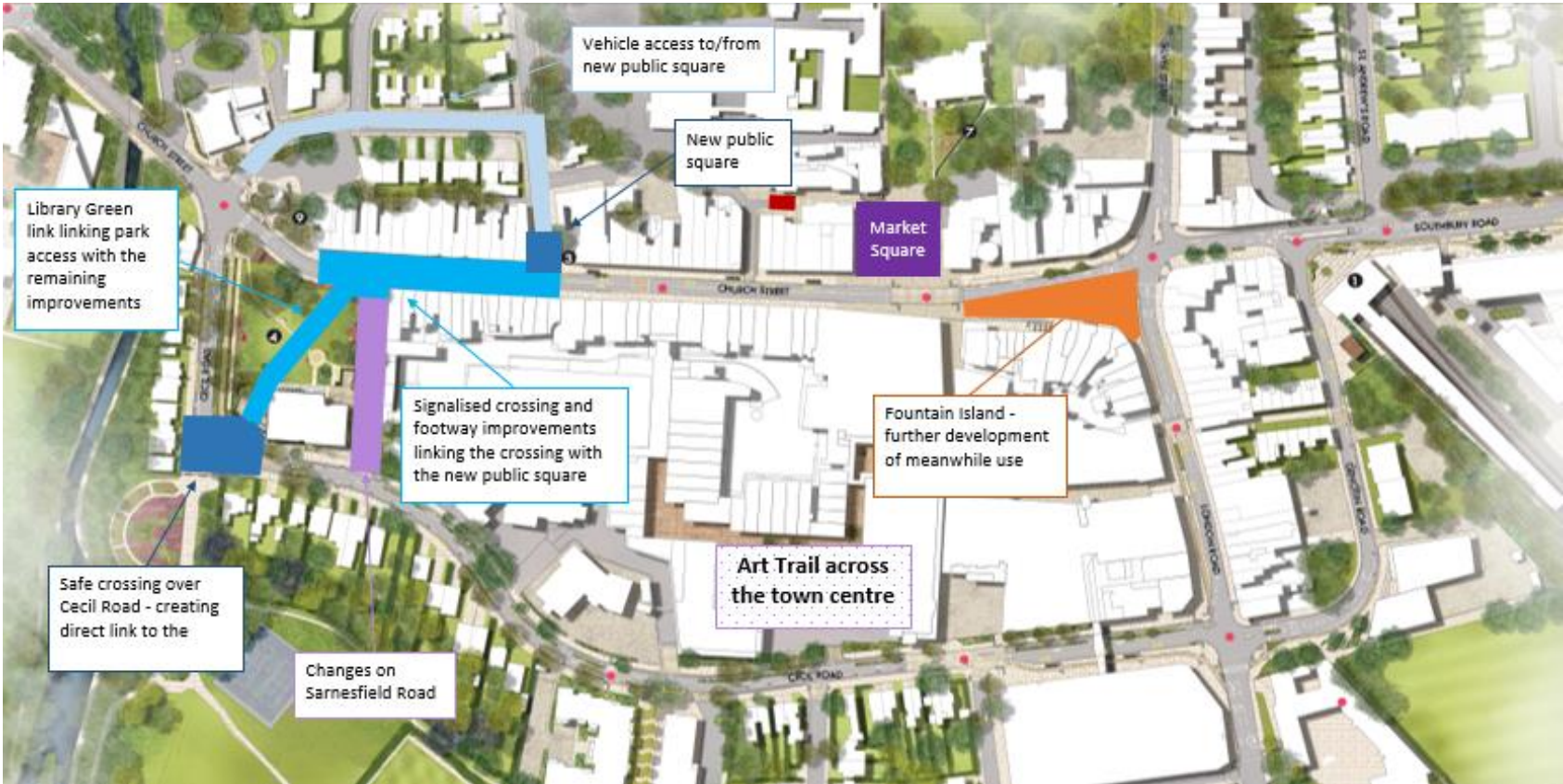

Phase 1 scope of works

Enfield Town Liveable Neighbourhood

New moveable seating is planned for Fountain Island with plans for installation later this year.

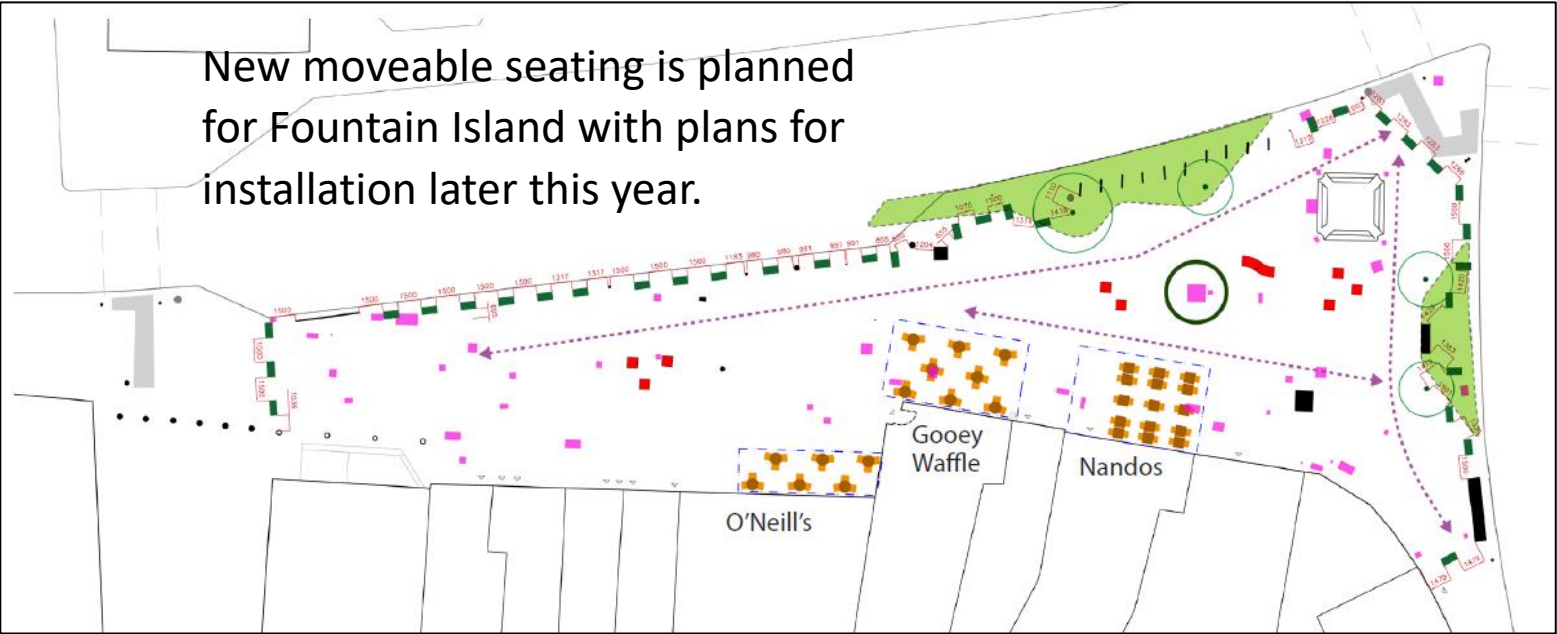

Enfield Town Arts Trail

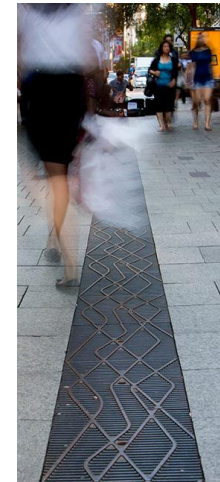
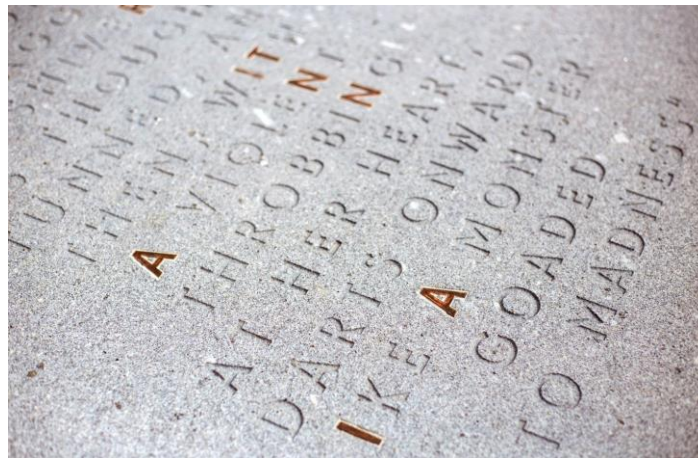
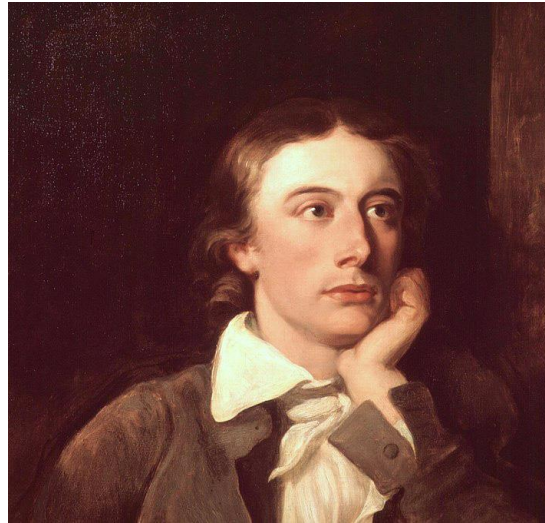
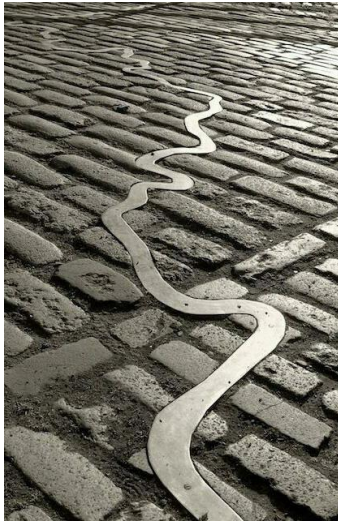

Curate Enfield Town



- A public art project led by local residents
- Will generate a mural for the alleyway between Deichman's & M&S in Palace Gardens
- Wider residents & communities have participated in creative sessions & shared their favourite places/memories of Enfield Town, to inform the design of the mural
- Mural expected to be installed by end October 2023

Angel Edmonton

Angel Yard



- 23 of 32 units taken
- 12 incubators, 11 commercial
- Bubble team, acting coach, fashion, beauty, accountants, microgreens, architects, photography, interior design, animation...
- X5 reserved for Trailblazers Hive (TBC)
- Bus fitout secured through UKSPF
- Community open day 14 Oct

Official Launch of Angel Yard at Open House 16 Sept 2023



Official Launch of Angel Yard – led by Cllr Anyanwu & key partners including GLA, Launch It, Jan Kattein, BLOQs etc.

Celebrating Angel Yard/Living Room Library & Fore Street Murals as exemplar projects as part of Open House weekend 2023

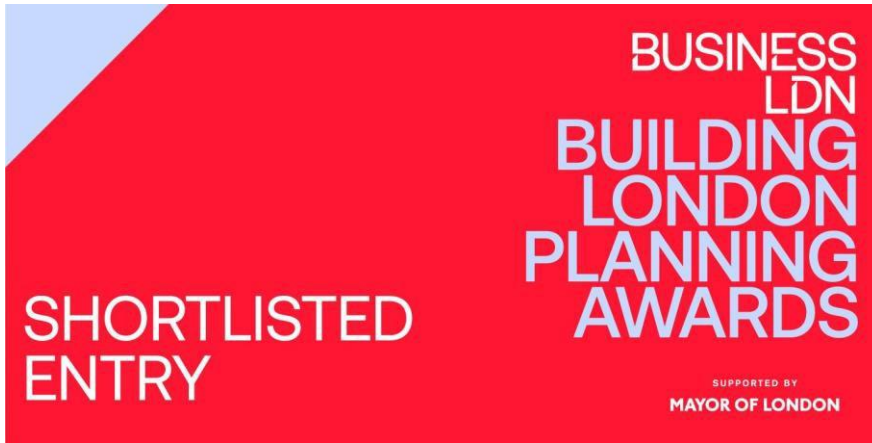

**‘Highly Commended’
in Best Borough-led
Project category**

Winner of
Fostering a
healthy town
centre

**PLANNING
AWARDS 2023
SHORTLIST**



Living Room Library



The Pineapples
**Creative
Retrofit 2022
winner**

**Fore Street
Living Room
Library,
Enfield**



Fore Street Murals



Fore Street for All

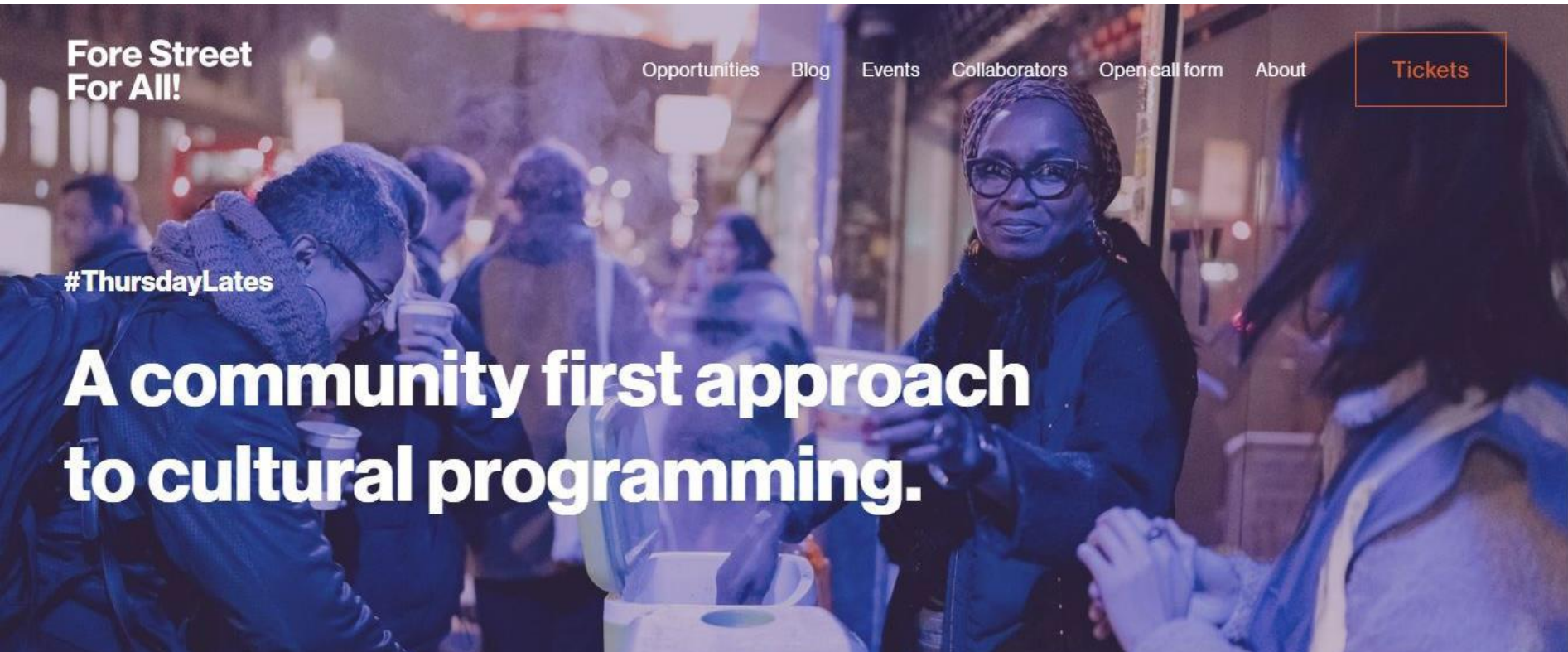

- High Street for All funded programme now complete
 - Brought together over 8,500 members of the community
 - 12 evening events and three festivals.
 - Supported 16 other high street venues and as well as 128 creatives, individuals and businesses to host and deliver the programme.
- UKSPF funded commission to support strategy and next steps

Curate Angel Edmonton



- A public art project led by local residents
- Wider residents & communities have participated in workshops creatively responding to the theme of 'Angel'
- Their ideas will be incorporated in to a sculptural artwork which will provide a public welcome for residents and visitors to Angel Edmonton
- Due to be installed Oct/Nov 2023

Edmonton Green

Edmonton Green Development Update



The Green

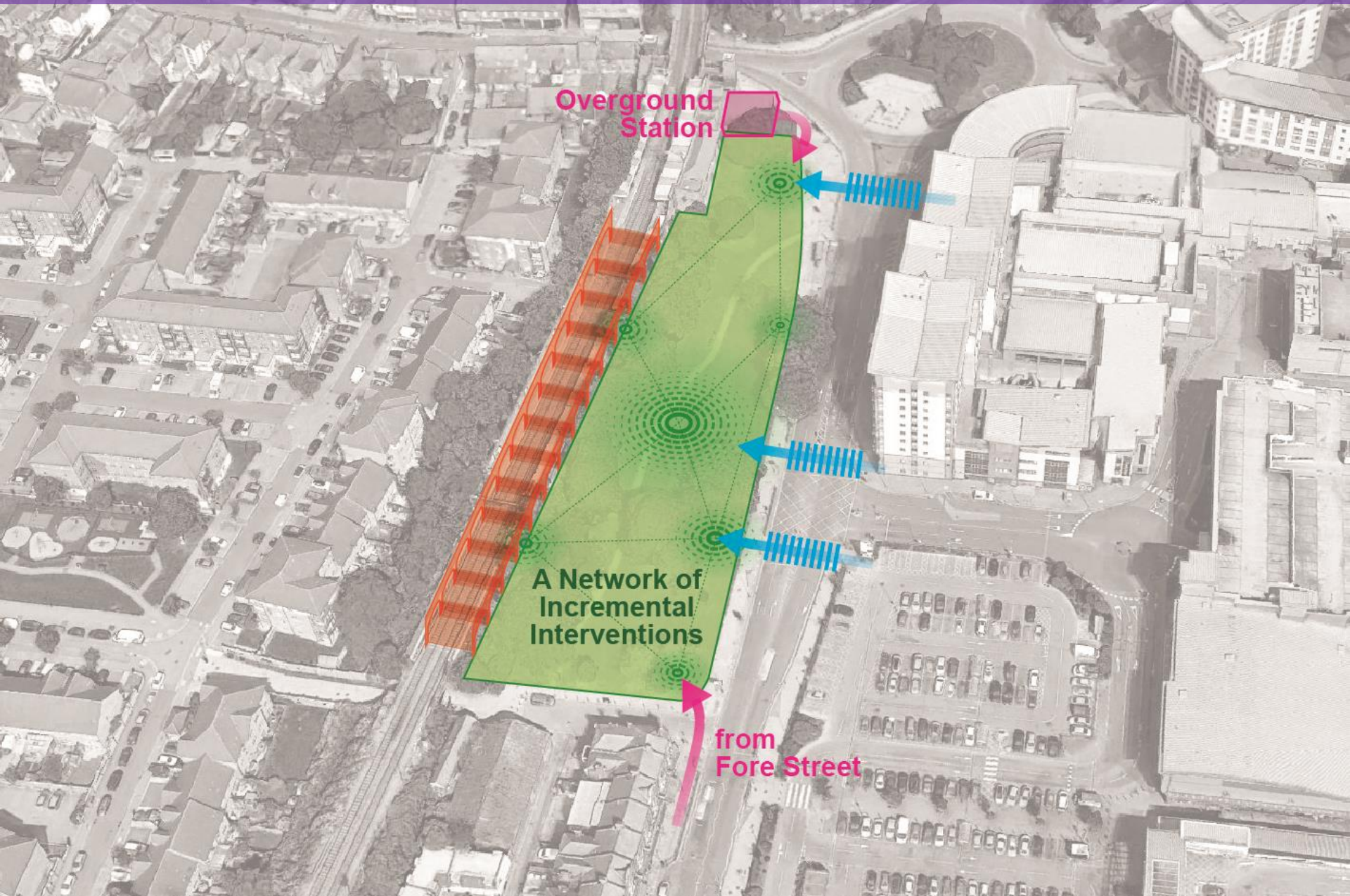

Overground
Station

A Network of
Incremental
Interventions

from
Fore Street

The Green

2023

2024

2025

2026

Launch Phase *Summer '23*

- Community mapping
- Engagement events
- Create “Friends of The Green” group
- Co-Design activities

Pavilion on The Green *Summer '24 & beyond*

- Temporary Pavilion
- Programme of cultural and community events
- Untold Edmonton Festival (Sept '24)

The Green Redevelopment *2026 & beyond* *(supported by S106)*

- Improved blue-green infrastructure
- Outdoor communal spaces
- Explore the restoration of Railway Arches

The Green



The Green

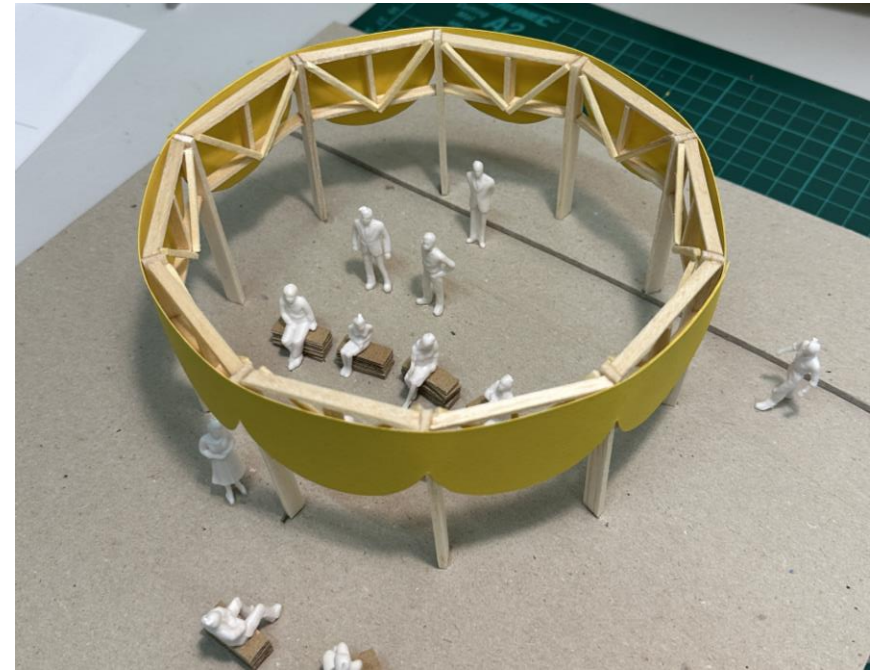
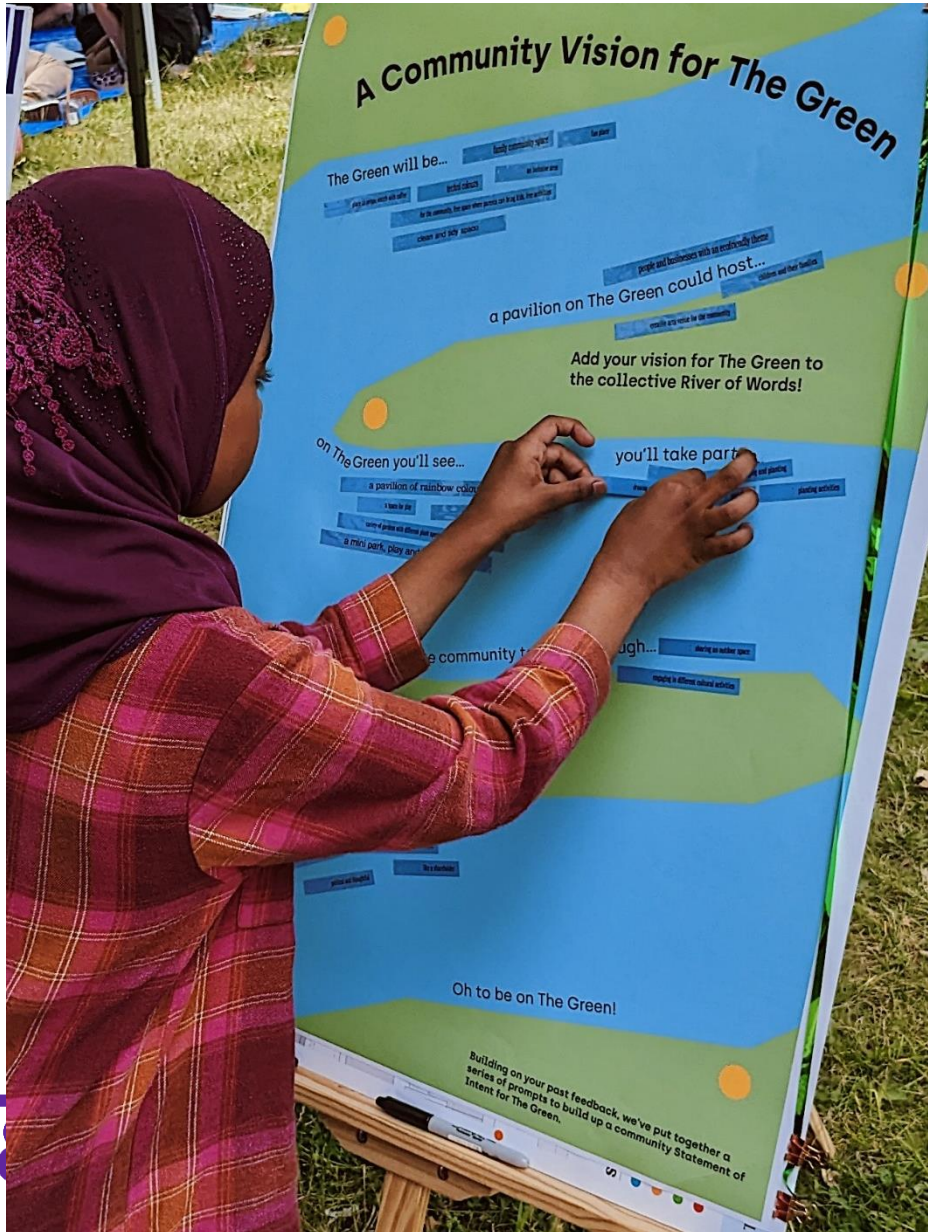

Palmers Green

Devonshire Square



- UKSPF capital allocated to deliver permanent scheme to develop Devonshire Square for markets, alfresco dining delivered by local cafes and cultural/community events
- Engagement expected to commence at autumn market on 14 Oct
- Completion by Feb'25



Arbeit Studios: Green Lanes

Arbeit – an Additional Restrictions Grant Recipient, are delivering a 3 year programme including:

- Community & Local Makers Market in their workspace & Devonshire Square
- Artist Residencies celebrating the High Street/local communities
- Local Creative Industry Support
- High Street and Community and Creative Programme - including curating a programme for Devonshire Square



Curate Palmers Green



- A public art project led by local residents
- Will generate an arts trail in/around Green Lanes & Aldermans Hill
- Design of murals informed by residents creative responses to the cultural & bio-diversity of Palmers Green
- Arts Trail expected to be installed by end October 2023

Southgate

Southgate @ 90



Reimagine the Everyday Experience

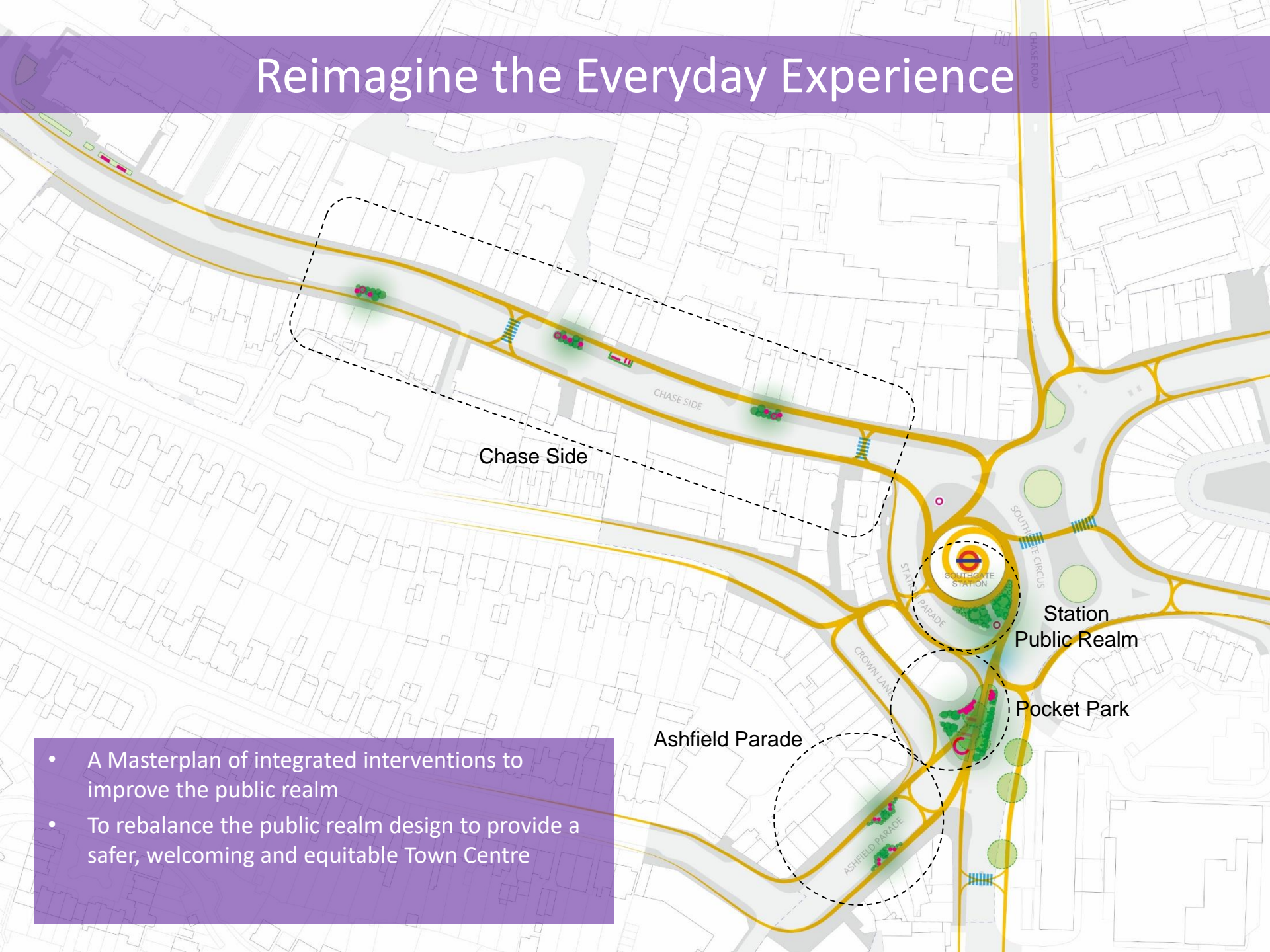

Chase Side

Ashfield Parade

Station
Public Realm

Pocket Park

- A Masterplan of integrated interventions to improve the public realm
- To rebalance the public realm design to provide a safer, welcoming and equitable Town Centre

Ashfield Parade Parklets



- GLA grant to support engagement with local businesses
- Make Ashfield Parade greener, more attractive to families and customers

Ashfield Parade Parklets



Station Pocket Park



- Pocket Park selected as priority site during walkabout in May '22

Station Pocket Park

The outlined proposal comprises of two key actions:



reference: 'Tree Trunk Bench' by Jürgen Bey, Droop Design



Introduce new seating carved out of natural oak felled tree trunks, with inscribed quotes and sculptural elements that celebrate the history of the Enfield Chase in three key moments.



Support educational community-led planting workshops to enhance biodiversity of micro-forest and re-introduce native species from ancient woodland.

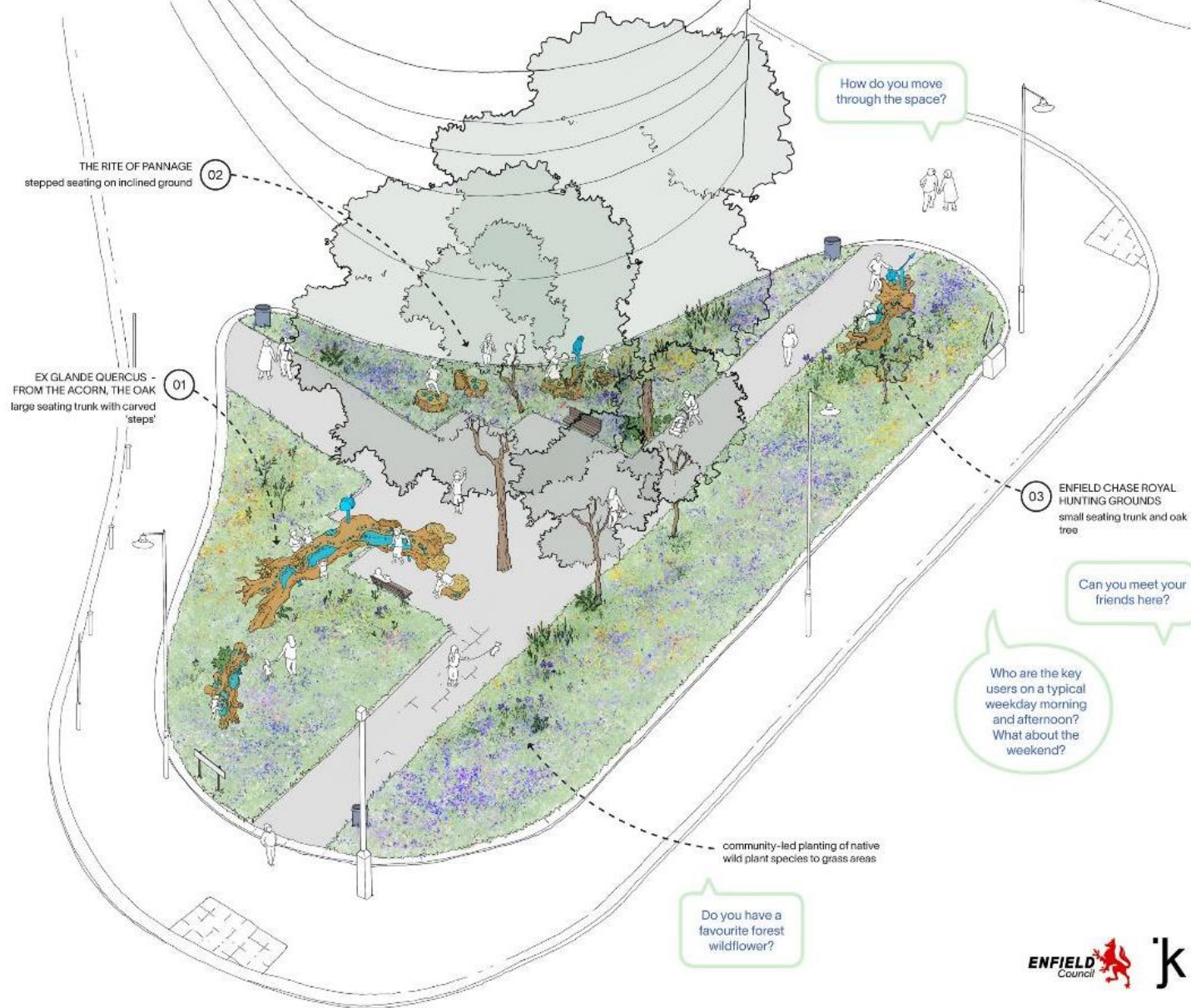

Chase Side – Engagement & Public Realm



- Create spaces where people can feel at ease in the midst of a heavily congested environment
- Walkabout with businesses and local community groups w/c 18th Sept

Thank you